

**OFFICER DELEGATION SCHEME
RECORD OF OPERATIONAL DECISION**



TO BE UPLOADED TO THE E-MEETINGS MANAGER

Date: 13.03.19	Ref No: 3258
Type of Operational Decision:	
Executive Decision <input checked="" type="checkbox"/>	Council Decision <input type="checkbox"/>
Status: For publication	
Title/Subject matter: Factory Street, Ramsbottom – Proposed application for a crane to oversail	
Budget/Strategy/Policy/Compliance – Is the decision:	
(i) within an Approved Budget	✓
(ii) not in conflict with Council Policy	✓
(iii) not raising new issues of Policy	✓
Equality Analysis [Does this decision change or make policy; change or make procedure or working practice? An Equality Analysis must be completed to assess the impact on equality and the relevance of the Public Sector Equality Duty. This should be signed off by your departmental equality representative and accompany this decision form. Please forward a copy to the Equality email for publication].	No
	Signed: (By EA Officer)
	Date:
Details of Operational Decision Taken [with reasons]:	
Approval to an application for consent to a proposal by Traffic Direct Limited to oversail the highway on Factory Street, Ramsbottom under Section 178 of the Highways Act 1980 from 25 March 2019 (0800hrs) to 25 March 2019 (1700hrs).	
Decision taken by:	Signature:
D R Giblin Head of Engineering	
	Date:
	18/03/19
Members Consulted [see note 1 below]	
Cabinet Member/Chair	
Lead Member	
Opposition Spokesperson	



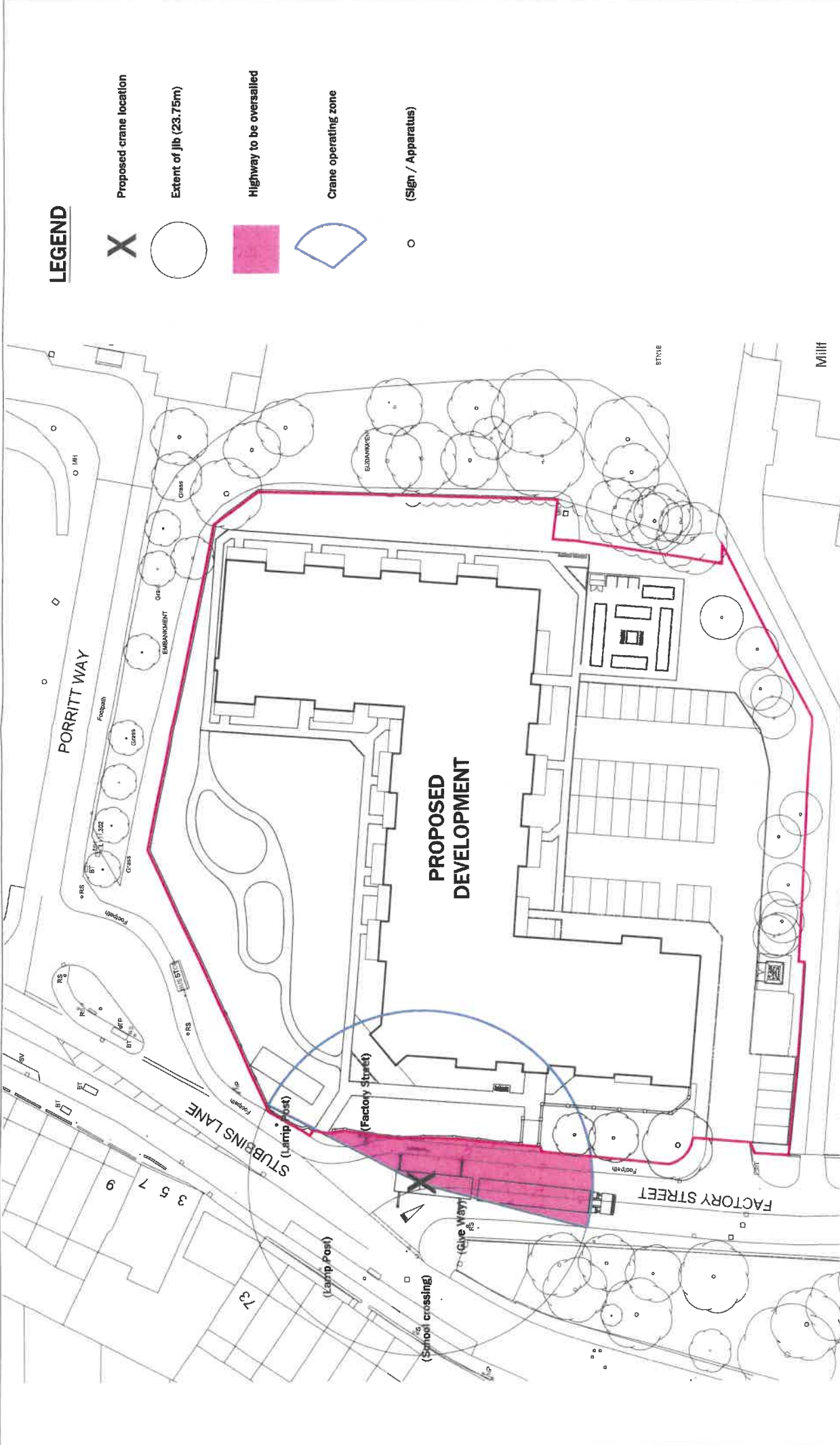

Notes

1. It is not generally a requirement to consult with any Members on Operational Decisions but where an Executive Director considers it necessary to consult with the appropriate Cabinet Member and/or Lead Member, they must sign the form so as to confirm that they have been consulted and that they agree with the proposed action. The signature of the Opposition Spokesperson should be obtained to confirm that he/she has been consulted.
2. **This form must not be used for urgent decisions.**

January 2015

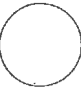

LEGEND

-  Proposed crane location
-  Extent of jib (23.75m)
-  Highway to be oversailed
-  Crane operating zone
-  (Sign / Apparatus)

Drawn by	MR	Issue date	Feb'19.
Scale(s)	1:500 @ A3		
Drawing No	06570	LP190227	

Project	Factory Street RAMSBOTTOM		
Title	Proposed Crane Oversail Layout		

Rev	Date	By	Revision notes
PRELIMINARY			

GLADMAN
 Gladman House, Alexandra Way
 Congleton Business Park
 Congleton, Cheshire
 CW17 1LB
 Tel: 01260 238800
 Fax: 01260 238801
 www.gladman.co.uk



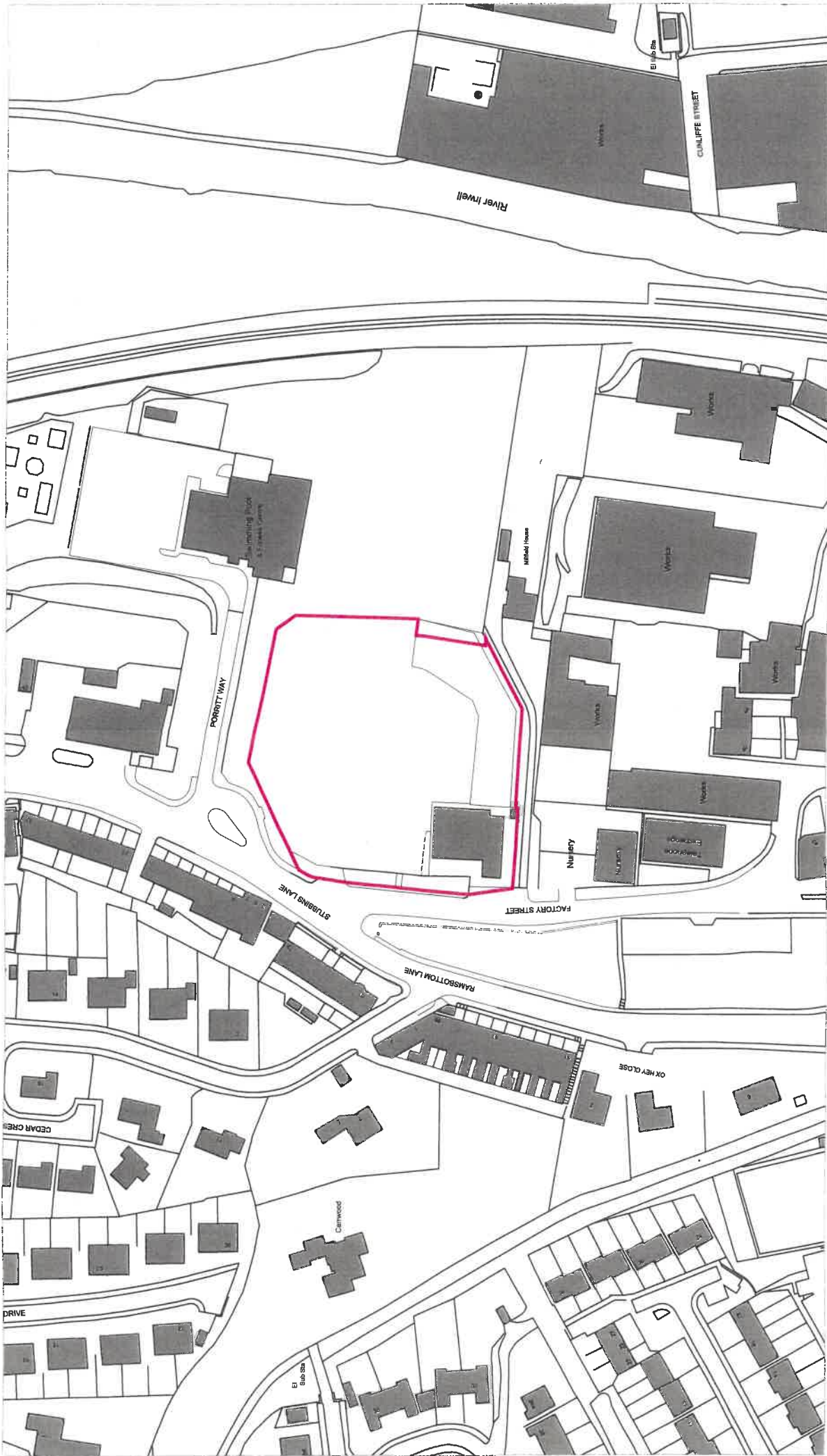

Issue date	July 2015
Rev	
Scale(s)	1:1250 @ A3
Drawing No	06570
Drawing No	P1 - 101

Drawn by	TW
Project	Factory Street RAMSBOTTOM
Title	SITE LOCATION PLAN

Rev	Date	By	Revision notes
PLANNING			

ADLINGTON

Independent living with care

ALL DIMENSIONS TO BE CHECKED ON SITE
DO NOT SCALE THIS DRAWING - WORK TO FIGURED DIMENSIONS ONLY
REPORT DISCREPANCIES TO THE ARCHITECT AT ONCE BEFORE PROCEEDING
COPYRIGHT ACT APPLIES